

4-CYCLE — AIR COOLED — HORIZONTAL CRANKSHAFT ENGINES 6:1 REDUCTION

MODELS	HR20A	HR25A	HR30A
Horsepower	2.00	2.50	3.00
Bore	2-1/8"	2-5/16"	2-5/16"
Stroke	1-3/4"	1-3/4"	1-13/16"
Displacement	6.207 C.I.	7.35 C.I.	7.61 C.I.
Air Cleaner	Dry	Dry	Dry

The above HR models are the same as models H20A, H25A and H30A, respectively, except for those parts illustrated and listed on page 2, see reverse side.

For parts other than those listed on reverse side of this sheet use parts list and exploded view drawing for Basic Engine Models H20A, H25A and H30A respectively with following exception.

Ref. No. 24, Part No. 27676, Oil Seal, is not used on the HR models.

The gear reduction unit is serviced with the same oil as the engine crankcase, see No. 21358 instruction plate, Ref. No. 118.

LAUSON

ENGINE DIVISION

TECUMSEH PRODUCTS COMPANY

NEW HOLSTEIN, WIS.

Service Throughout the World

Quality leader of small

4-cycle engines since 1896

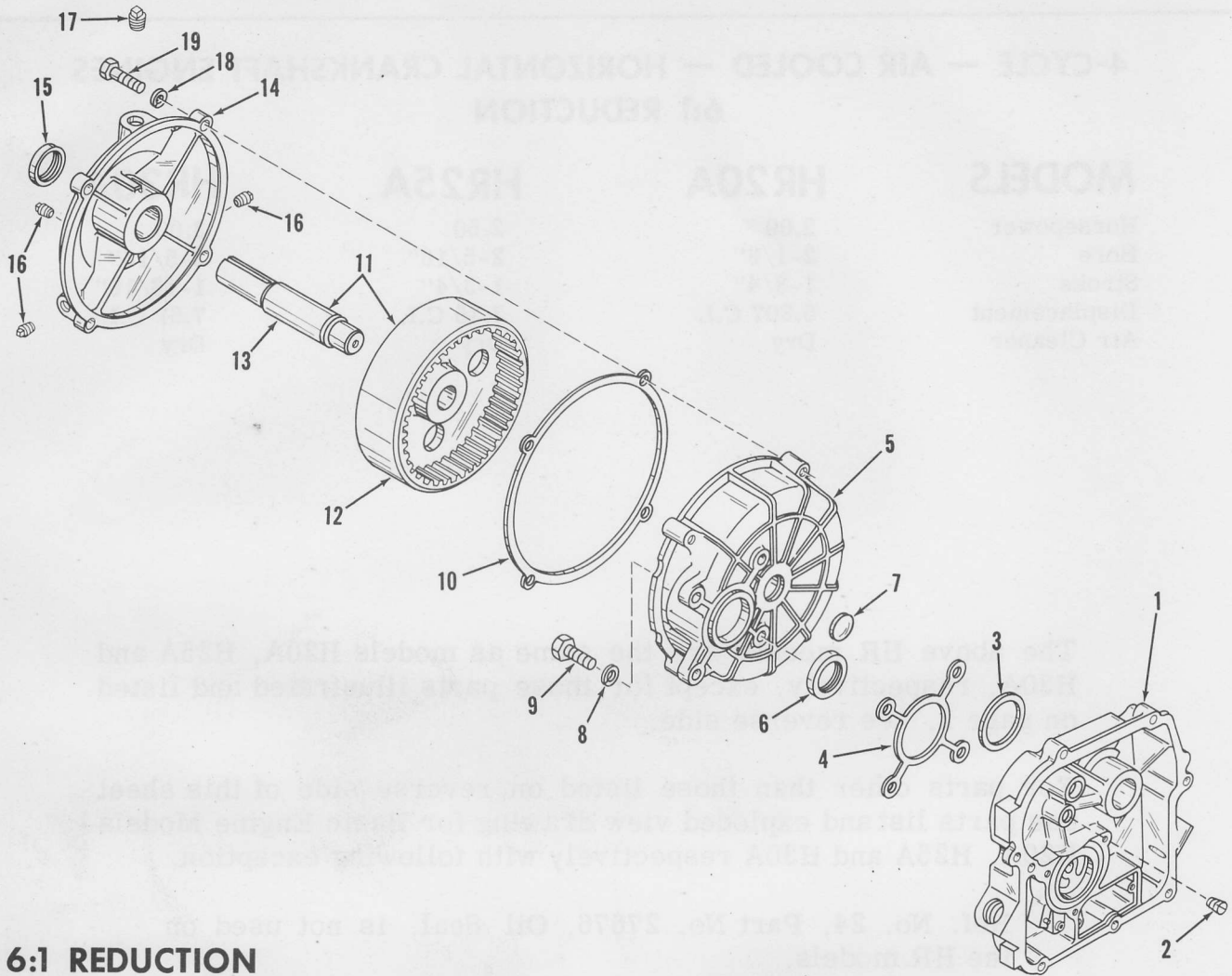

6:1 REDUCTION

Ref. No.	Part No.	Description	Models & No. Req.	HR20A	HR25A	HR30A
1	28446	Cover, Cylinder (Incl. No. 2)		1	1	1
2	27678	Plug, Oil passage		1	1	1
3	28451	Gasket		1	1	1
4	28452	Gasket, Housing to cylinder cover		1	1	1
5	28448	Housing, Speed reducer (Incl. Nos. 6 & 7)		1	1	1
6	27676	Seal, Oil		1	1	1
7	28508	Plug, Expansion		1	1	1
8	8274	Lockwasher, Med. split, 5/16		4	4	4
9	28454	Screw, Hex hd. cap, 5/16-24x7/8		4	4	4
10	28453	Gasket, Speed reducer cover		1	1	1
11	28449	Shaft & Gear Assembly (Incl. Nos. 12 & 13)		1	1	1
12	28510	Gear, Internal tooth		1	1	1
13	28509	Shaft, Speed reducer		1	1	1
14	28450	Cover, Speed reducer (Incl. Nos. 15 & 16)		1	1	1
15	27676	Seal, Oil		1	1	1
16	9556	Pipe Plug, Square hd., 1/8-27		3	3	3
17	24590	Pipe Plug, Square hd.		1	1	1
18	8303	Lockwasher, Heavy, split, 1/4		4	4	4
19	6005	Screw, Hex hd. cap, 1/4-20x1		4	4	4